

ADVANCE PROGRAM

Joint Workshop on

OPS & OCDMA

----- Optical Network Technology for New Era

Conference Co-Chairs:

Prof. Shizhong Xie, Department of Electronic Engineering,
Tsinghua University, China

Dr. Naoya Wada, Phonics network group,
New generation network research center, NICT, Japan

Dr. Xu Wang, Phonics network group,
New generation network research center, NICT, Japan

Sponsored by:



Tsinghua University, Beijing , China

December 4-5, 2006

Conference Arrangement

Venue

Video Conference Hall, Central Main Building, Tsinghua University, Beijing, China

Shuttle Bus

1. Beijing International Airport —→ Crowne Plaza Park View Wuzhou Beijing
Departure time: 14:40, Dec. 3th
Arrival time: 15:30, Dec. 3th
2. Crowne Plaza Park View Wuzhou Beijing —→ Tsinghua University
Departure time: 8:00, Dec. 4th and 5th
Arrival time: 9:00, Dec. 4th and 5th
3. Tsinghua University —→ Crowne Plaza Park View Wuzhou Beijing
Departure time: 20:30, Dec. 4th
Arrival time: 21:10, Dec. 4th
4. Crowne Plaza Park View Wuzhou Beijing —→ Fangshan Restaurant (Banquet)
Departure time: 18:00, Dec. 5th
Arrival time: 19:00, Dec. 5th
5. Fangshan Restaurant —→ Crowne Plaza Park View Wuzhou Beijing
Departure time: 21:00, Dec. 5th
Arrival time: 22:00, Dec. 5th
6. Crowne Plaza Park View Wuzhou Beijing —→ Beijing International Airport
Departure time: 12:30, Dec. 6th
Arrival time: 13:10, Dec. 6th

Lunch

Time: 12:30 - 14:00, Dec. 4th and 5th.

Place: Jinchunyuan Hotel, Tsinghua University

Welcome Reception

Time: 18:30 - 20:30, Dec. 4th.

Place: Jiasuo Hotel, Tsinghua University

Banquet

Time: 19:30 – 21:30, Dec. 5th.

Place: Fangshan Restaurant, Beijing

Walking in Tsinghua University

It takes 20 minutes to walk from Jinchunyuan Hotel to Central Main Building.

It takes 10 minutes to walk from Jiasuo Hotel to Central Main Building.

The interval of shuttle bus in Tsinghua University is about 15 minutes from the West Gate to the Central Main Building, and the fee is 2RMB/person.

Contact Information

Tel: +86-10-62784784, +86-10-62788161

Secretariat: Dr. Ming Chen (Mobile Phone: 86-13811131058)

Dr. Hongwei Chen (Mobile Phone: 86-13661386624)

会议地点：清华大学中央主楼二楼视频会议大厅

往返班车

1. 北京国际机场 ——> 北京五洲皇冠假日酒店
发车时间: 14:40, Dec. 3th
到达时间: 15:30, Dec. 3th
2. 北京五洲皇冠假日酒店 ——> 清华大学
发车时间: 8:00, Dec. 4th and 5th
到达时间: 9:00, Dec. 4th and 5th
3. 清华大学 ——> 北京五洲皇冠假日酒店
发车时间: 20:30, Dec. 4th
到达时间: 21:10, Dec. 4th
4. 北京五洲皇冠假日酒店 ——> 仿膳饭庄 (晚宴)
发车时间: 18:00, Dec. 5th
到达时间: 19:00, Dec. 5th
5. 仿膳饭庄 ——> 北京五洲皇冠假日酒店
发车时间: 21:00, Dec. 5th
到达时间: 21:40, Dec. 5th
6. 北京五洲皇冠假日酒店 ——> 北京国际机场
发车时间: 12:30, Dec. 5th
到达时间: 13:10, Dec. 5th

午餐

时间: 12:30 - 14:00, Dec. 4th and 5th.
地点: 近春园, 清华大学

招待宴会

时间: 18:30 - 20:30, Dec. 4th.
地点: 甲所, 清华大学

晚宴

时间: 19:30 - 21:30, Dec. 5th.
地点: 仿膳饭庄, 北京

校内交通信息

从近春园到中央主楼步行需要 20 分钟

从甲所到中央主楼步行需要 10 分钟

从清华西门到中央主楼有校内交通车通行, 招手上车, 每人 2 元, 间隔约为 15 分钟

联系方式

电话: 86-10-62784784, 86-10-62788161
秘书: 陈明 (手机: 86-13811131058)
陈宏伟 (手机: 13661386624)

Useful Chinese Expressions (You can show these to taxi driver)

Please take me to Tsinghua University.

请带我到清华大学。

Please take me to the East Gate of Tsinghua University.

请带我到清华大学东门。

Please take me to Crowne Plaza Park View Wuzhou Beijing.

请带我到北京五洲皇冠假日酒店。

How are you?

你好！

Thank you.

谢谢！

How much is it?

多少钱？

Information of the hotel



北京五洲皇冠假日酒店

中国北京市朝阳区北四环 中路 8 号

邮编 100101

(Crowne Plaza Park View Wuzhou Beijing).

座落於北京北部，毗鄰北京國際會議中心，步行即可到達
2008 奧林匹克公園，距離首都國際機場僅 25 分鐘車程

Crowne Plaza Park View Wuzhou Beijing

8 North Si Huan Zhong Road, Chaoyang District

Beijing 100101, P.R.China

Tel: (8610) 8498 2288

Fax: (8610) 8499 2933

Map of Beijing (part) 北京地图（部分）



Map of Tsinghua University 清华地图

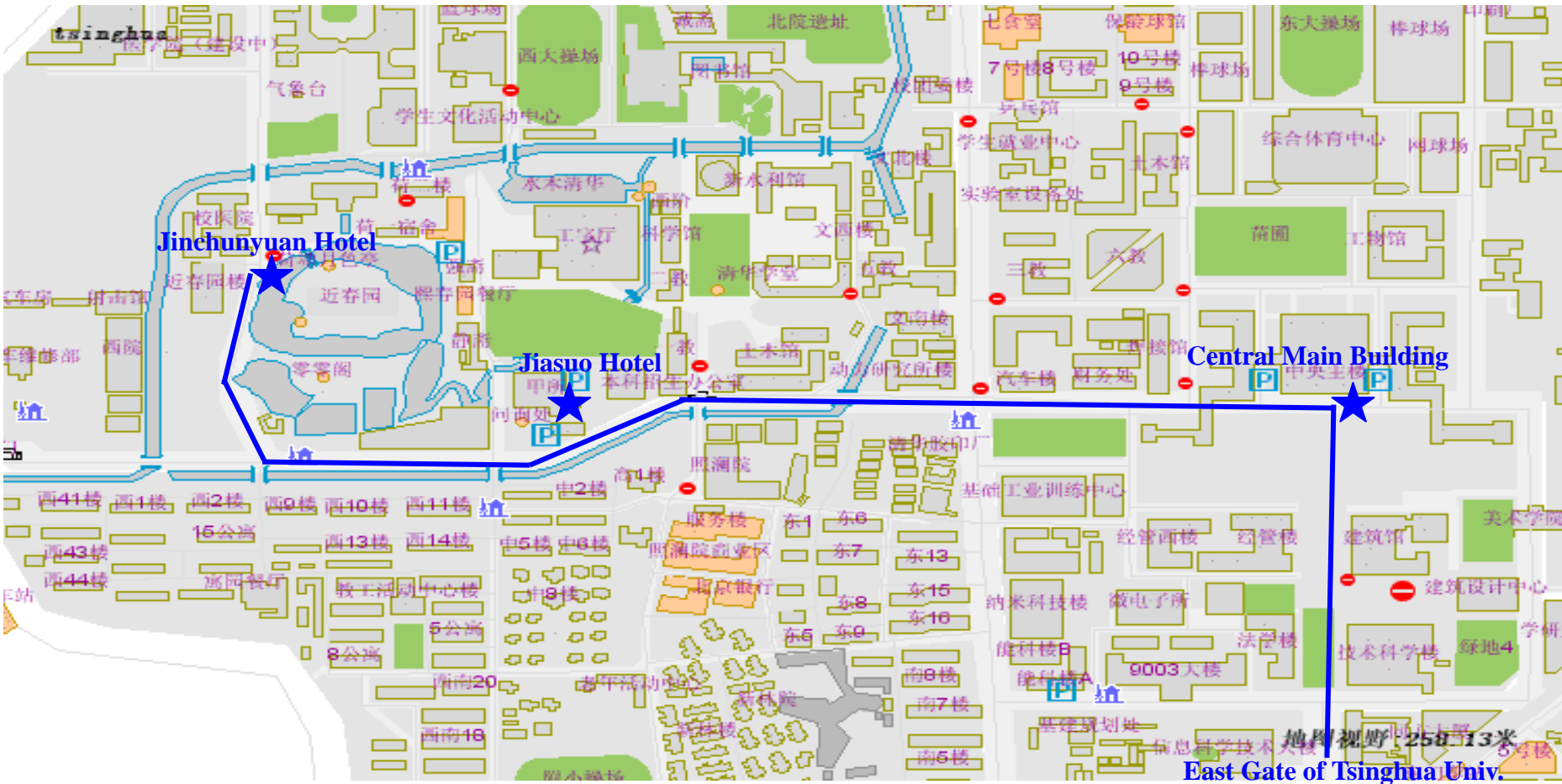

Central Main Building 中央主楼

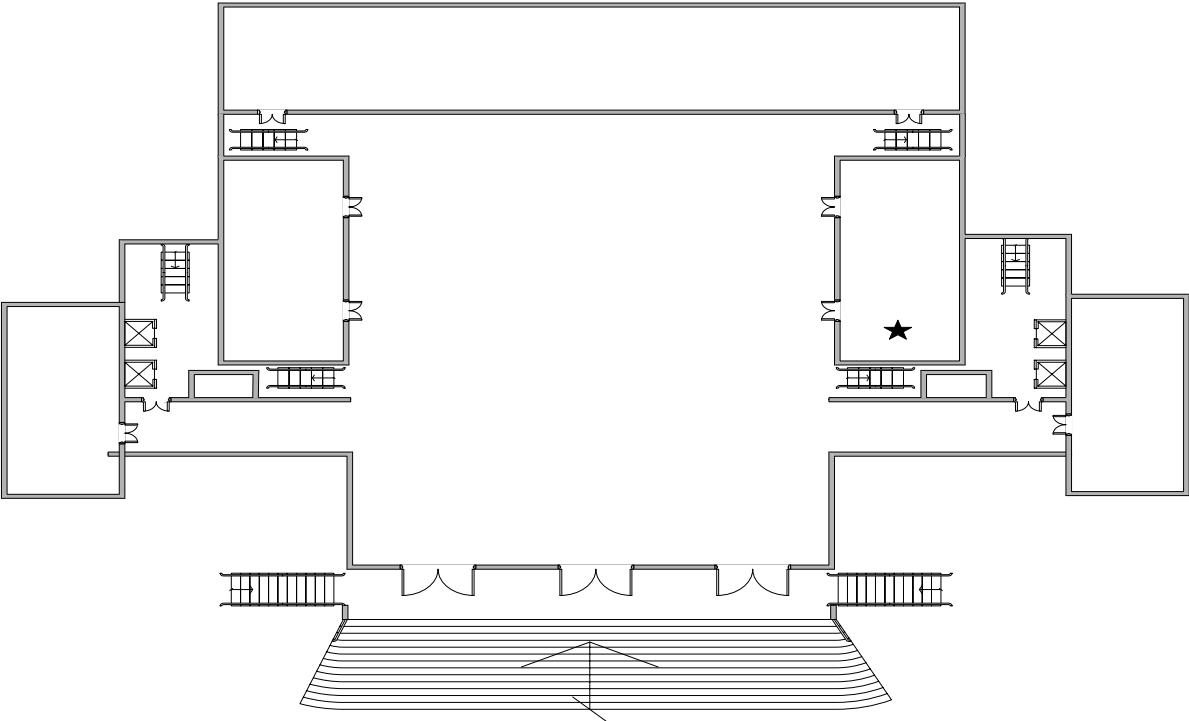

向上

Network

Center

elevator

Network

7

WC

Center

Lobby

Program of joint workshop on OPS and OCDMA

Day 1: 12/4/2006

Venue: Tsinghua University

Opening

Chair: Prof. Zhisheng Niu

TBD	Tsinghua	China	Opening	9:00~9:05
Dr. Matsushima (VP)	NICT	Japan	Opening	9:05~9:15
Prof. Shizhong Xie	Tsinghua	China	Opening	9:15~9:30

Keynote speeches

Chair: Prof. Shizhong Xie

Prof. Heritage	UC Davis	USA	Optical CDMA Technologies	Keynote	9:30~10:00
Prof. Ben Yoo	UC Davis	USA	Next Generation Photonic Internet	Keynote	10:00~10:45

Coffee Break

10:45~11:00

Prof. K. Kitayama	Osaka U	Japan	Key Enablers for Future Photonic Platforms beyond NGN: OCDMA and OPS	Keynote	11:00~11:45
Prof. Weisheng Hu	SJTU	China	Optical Switching and Networking Research in Mainland China	Keynote	11:45~12:30

Lunch Break

12:30~14:00

Prof. T. Koonen	ETI	NL	Recent Research Activities in the COBRA Institute on Photonic Networks	Keynote	14:00~14:45
-----------------	-----	----	--	---------	-------------

Coffee Break

14:45~15:00

OCDMA workshope

Chairs: Prof. ZH Feng, Dr. Xu Wang

Dr. Xu Wang	NICT	Japan	Multi-user Coherent Code-shift-keying OCDMA System	15:00~15:15
Dr. Biao Chen	ZJU	China	Optical add/drop multiplexing in OCDMA ring networks	15:15~15:30
Prof. G. Cincotti	Rome	Italy	A multi-port encoder/decoders and itapplications to OCDMA networks	15:30~15:45
Dr. Yitang Dai	NJU	China	High-chip-count, high-performance OCDMA en/decoders using reconstruction equivalent-chirp technolog	15:45~16:00
Prof. Oshiba	KIT	Japan	Optical code generation using optical correlator based on super-structured fiber Bragg grating	16:00~16:15
Dr. Tao Pu	NICE	China	Evaluatoin of Noises and Interferences in OCDMA System	16:15~16:30
Prof. Shuwen Yang	SZU	China	TBD	16:30~16:45

Coffee Break

16:45~17:00

Panel discussion

Moderator: Prof. K. Kitayama

17:00~18:00

Pannelists: Prof. K. Kitayama, Prof. Shizhong Xie, Prof. G. Cincotti, Dr. X. Wang

Reception

18:30~20:30

Day 2: 12/5/2006

Venue: Tsinghua University

OPS workshop

Seesion 1: Optical label processing techniques

Chairs: Dr. Naoya Wada

Prof. Konishi	Osaka U	Japan	Optical Label Recognition assisted by Optical Signal Processing	9:00~9:15
Dr. Hongwei Chen	Tsinghua	China	High spectral efficiency schemes in 40Gb/s optical label switching networks	9:15~9:30
Prof. Uenohara	TIT	Japan	Optical Label Processing Scheme using Optical Digital-to-Analog Converters and Self-Gate Pulse Gener	9:30~9:45
Dr. T. Kawanishi	NICT	Japan	High-speed optical FSK modulator for optical packet system	9:45~10:00
Dr. S. Shinada	NICT	Japan	Novel optical buffer memory for optical packet switch by using single-flux-quantum circuit	10:00~10:15

Coffee Break

10:15~10:45

Seesion 2: OPS network I

Chair: Prof. Minghua Chen

Prof. Ohta	TIT	Japan	Almost-all Optical Packet Switching with Optical Packet Multiplexing	10:45~11:00
Prof. Yaohui Jin	SJTU	China	Low-Jitter Scheduling for Input-Queued Switches	11:00~11:15
Dr. H. Imaizumi	Tokyo U	Japan	Introduction of OPS research in the University of Tokyo	11:15~11:30
Dr. Yongmei Sun	BUPT	China	Service-Driven Optical Switching Technology	11:30~11:45
Prof. Anshi Xu	PKU	China	Irregularly Arrayed Waveguide Grating	11:45~12:00

Lunch Break

11:45~13:00

Campus tour

13:00~14:00

Seesion 3: OPS system

Chair: Dr. Jian Wu

Prof. Minghua Chen	Tsinghua	China	Optical Label-Switching Network with Edge Aggregated Routers	14:00~14:15
Dr. N. Kataoka	NICT	Japan	Field Trial of Granularity-Flexible, Optical Network using Packet-Selective ROADM Prototype	14:15~14:30
Dr. Jian Wu	BUPT	China	All Optical Signal Processing Technologies	14:30~14:45
Dr. H. Furukawa	NICT	Japan	Development of 160 Gbit/s/port optical packet switch prototype and related technologies	14:45~15:00

Coffee break

15:00~15:15

Seesion 4: OPS network II

Chair: Prof. Yaohui Jin

Dr. H. Harai	NICT	Japan	Recent Topics of Optical Buffering and WDM Based Optical Packet Switching	15:15~15:30
Prof. Keping Long	UESTC	China	An Enhanced GMPLS Architecture for OBS Networks	15:30~15:45
Prof. H. Tode	Osaka U	Japan	Reflection-based Deflection Routing Scheme in OPS Networks	15:45~16:00
Dr. Zhengbin Li	PKU	China	OBS based transparent optical network	16:00~16:15

Coffee break

16:15~16:30

Panel discussion

Moderator: Prof. Koonen

Pannelists: Prof. Koonen, Prof. Kitayama, Prof. Weisheng Hu, Dr. Wada

16:30~17:30

Banquete & Closing

19:30~21:30